

WATERING SCHEDULE

While this Drought Contingency Plan is in effect, water customers are requested to continue to practice water conservation and to minimize or discontinue water use for non-essential or discretionary purposes

INSIDE CITY WATERING SCHEDULE

- The watering schedule for areas inside the City is shown below.
- The map showing the watering areas inside the City is shown on page 14.

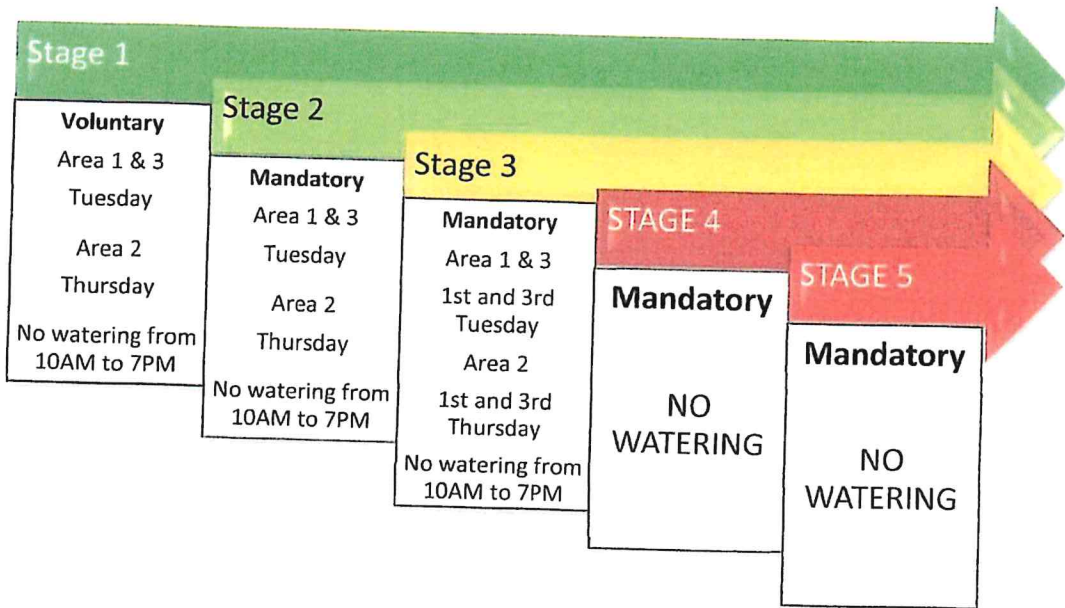

REVISED 5-22-14

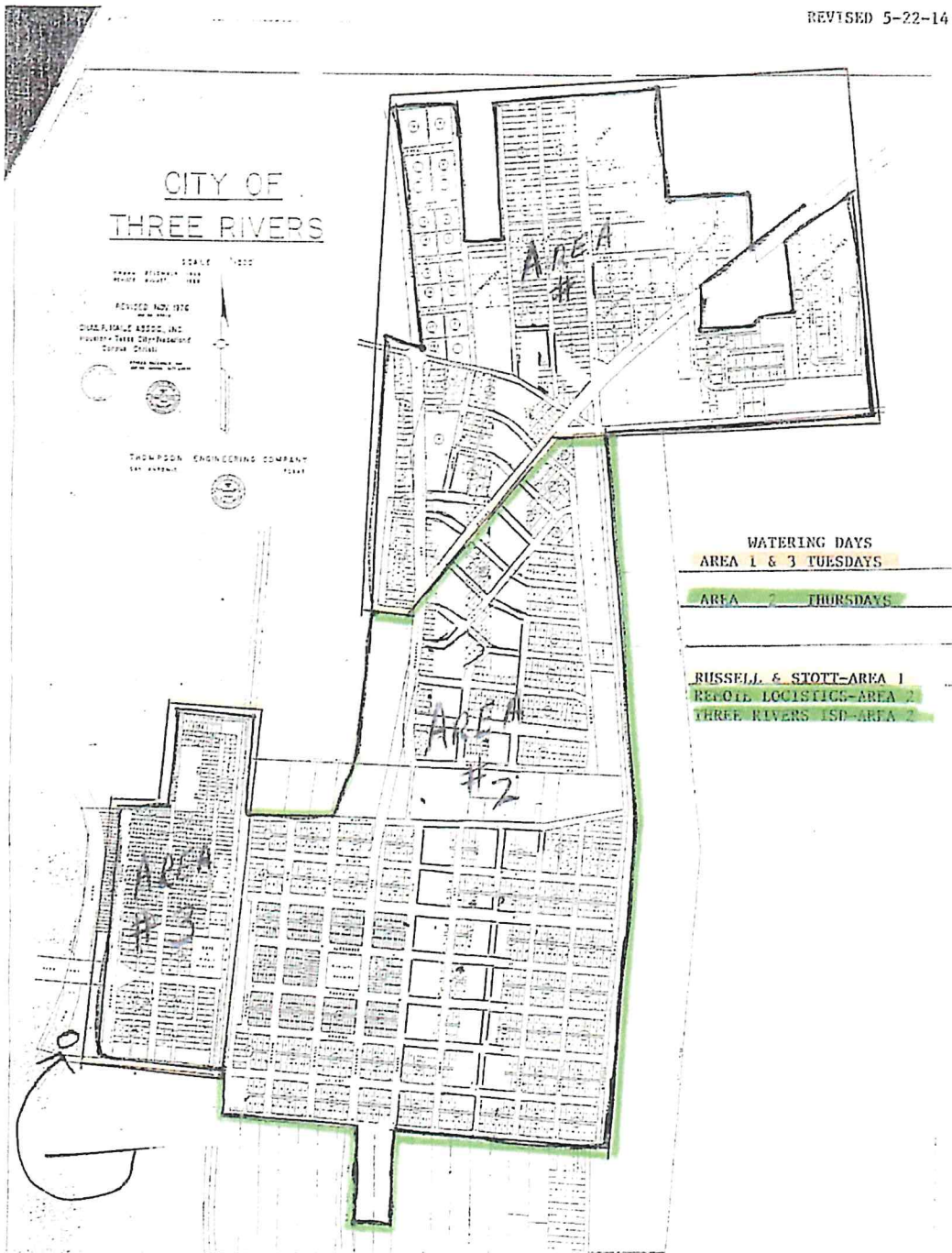

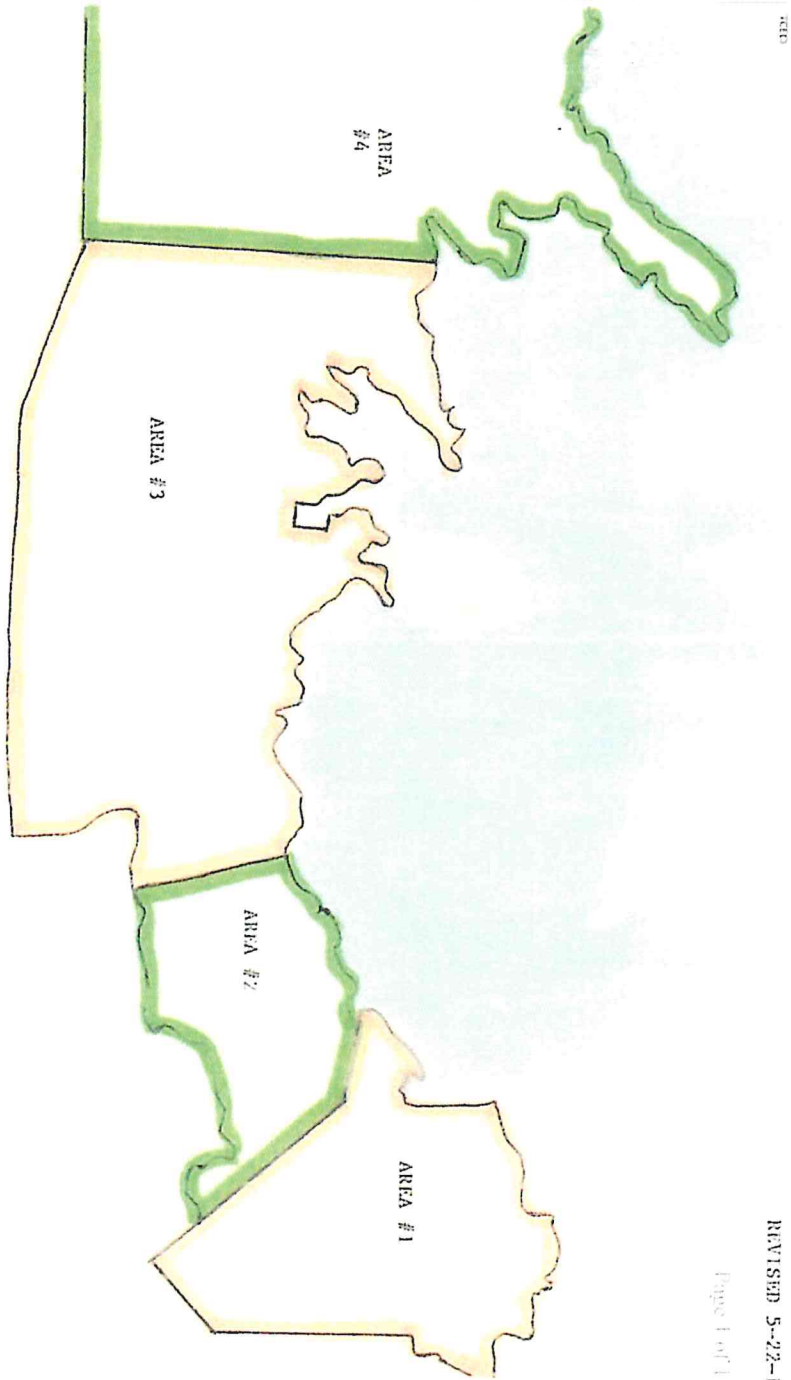

REID

REVISED 5-22-14

Page 4 of 11

- AREA #1-North & South of Hwy 72 W. from the city limits to Choke Canyon S.S. entrance
- AREA #2-From Choke Canyon S.S. entrance to FM 1042
- AREA #3-From FM 1042 to Wheeler Tanks & North of Rec. Road 7
- AREA #4-From Wheeler Tanks to North & South Hwy 99 & CR 306

WATERING DAYS
 AREAS 1&3 MONDAY
 AREAS 2&4 FRIDAY